



Spencer.

Kennedy Court, Tapton Crescent Road, S10

Rent —
this superbly presented two double bedroom
ground floor apartment.....Available NOW

— from *Spencer.*

- Available NOW
- Ground floor UNFURNISHED apartment
- Private entrance
- Two double bedrooms
- Fully fitted modern kitchen
- Shower room
- NO SMOKERS or PETS
- Council Tax Band B / EPC Rating E
- Holding Deposit £195
- Security Deposit £980



£850

PCM



Floorplan

GROUND FLOOR
579 sq.ft. (53.8 sq.m.) approx.

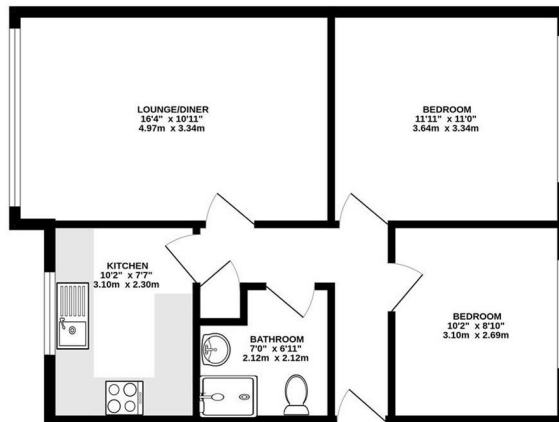

TOTAL FLOOR AREA: 579 sq ft. (53.8 sq.m.) approx.
Whilst every attempt has been made to ensure the accuracy of the foregoing, measurements of areas, volumes, heights and any other details are approximate and no responsibility is taken for any error, omission or misstatement. This plan is for illustrative purposes only and should be used as such by any prospective purchaser. The layout, fixtures and appliances shown here are not to be relied upon as to their operability or efficiency can be given. Made with RoomSketcher 2023

Spencer.

+44 (0)114 268 3682
info@spencersestateagents.co.uk
469 Ecclesall Road, Sheffield, S11 8PP
SpencersEstateAgents.co.uk

SpencersAgents
SpencersAgents
SpencersEstateAgents

All enquiries and negotiations conducted via the Spencers office. We are obliged under the Estate Agent Act 1991 to qualify all offers and an independent mortgage consultant will speak to you to substantiate your details. The particulars are set out as a general outline only for guidance and do not constitute part of an offer or contract. Measurements are given in good faith and believed to be correct. Any prospective buyer should satisfy themselves as to the correctness of all statements and should not rely on them as representation of fact. No person in the employment of Spencers has any authority to make or give representation or warranty whatever in relation to this property.

Viewing: Via the Agents
Spencers Agents Ltd, 469 Ecclesall Road, Sheffield S11 8PP | Registered in England No. 7565948