



Spencer.

119, Pomona Street, Off Ecclesall Road, S11 8JN

Buy —

ideally located for either an ongoing rental investment or first time buyer opportunity is this three double bedroom mid terrace home.

— from *Spencer.*

- NO CHAIN
- Investment or first time buyer opportunity
- Three double bedrooms
- Dining kitchen
- Lounge
- Storage cellar
- Rear yard and outhouse
- Council Tax Band-B
- EPC-D
- [What3Words///coins.string.fetch](#)

Offers Around

£195,000





Floorplan

Ground Floor
Approx. 30.9 sq. metres (332.1 sq. feet)

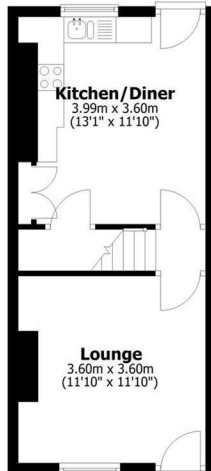

Ceiling Height = 2.67

First Floor
Approx. 30.9 sq. metres (332.1 sq. feet)

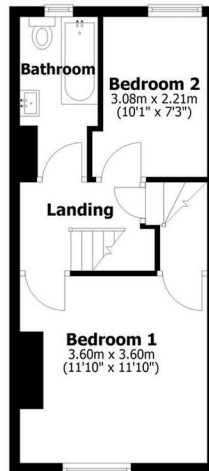

Ceiling Height = 2.73

Second Floor
Approx. 25.2 sq. metres (270.9 sq. feet)



Total area: approx. 86.9 sq. metres (935.1 sq. feet)

All measurements are approximate
Yorkshire EPC & Floor Plans Ltd
Plan produced using PlanUp.

119 Pomona Street

Spencer.

+44 (0)114 268 3682
info@spencersestateagents.co.uk

469 Ecclesall Road, Sheffield, S118PP
SpencersEstateAgents.co.uk

SpencersAgents
SpencersAgents
SpencersEstateAgents

All enquiries and negotiations conducted via the Spencers office. We are obliged under the Estate Agent Act 1991 to qualify all offers and an independent mortgage consultant will speak to you to substantiate your details. The particulars are set out as a general outline only for guidance and do not constitute part of an offer or contract. Measurements are given in good faith and believed to be correct. Any prospective buyer should satisfy themselves as to the correctness of all statements and should not rely on them as representation of fact. No person in the employment of Spencers has any authority to make or give representation or warranty whatever in relation to this property.

Viewing: Via the Agents
Spencers Agents Ltd, 469 Ecclesall Road, Sheffield S11 8PP | Registered in England No. 7565948