



Spencer.

Whirlow Croft Farm, 33 Whirlow Lane, Whirlow, S11 9QF

Buy —
the most wonderful five bedroomed detached
farmhouse beautifully presented with good
proportions, garage and a manicured garden

— from *Spencer.*

- A wonderful five bedroomed detached farmhouse
- New windows with 10-year warranty, new wiring, sockets and switches, new Vaillant boiler, new Honeywell zone controlled radiators, upgraded alarm system and utility room
- Newly decorated throughout in neutral complimentary tones
- Excellent proportions including open plan kitchen, dining, orangery with underfloor heating
- Two living rooms with views over the beautifully presented private south facing garden
- Study area overlooking the garden, downstairs WC, utility room and wine cellar
- Five double bedrooms, the primary bedroom with built in storage and en-suite bathroom
- Shower room and separate Heritage bathroom
- Driveway parking and integral garage with upgraded and serviced electric garage door
- EPC Rating -C Council Tax Band G -
What3Words:///impact.rocket.person

Offers Around

£1,250,000









Floorplan

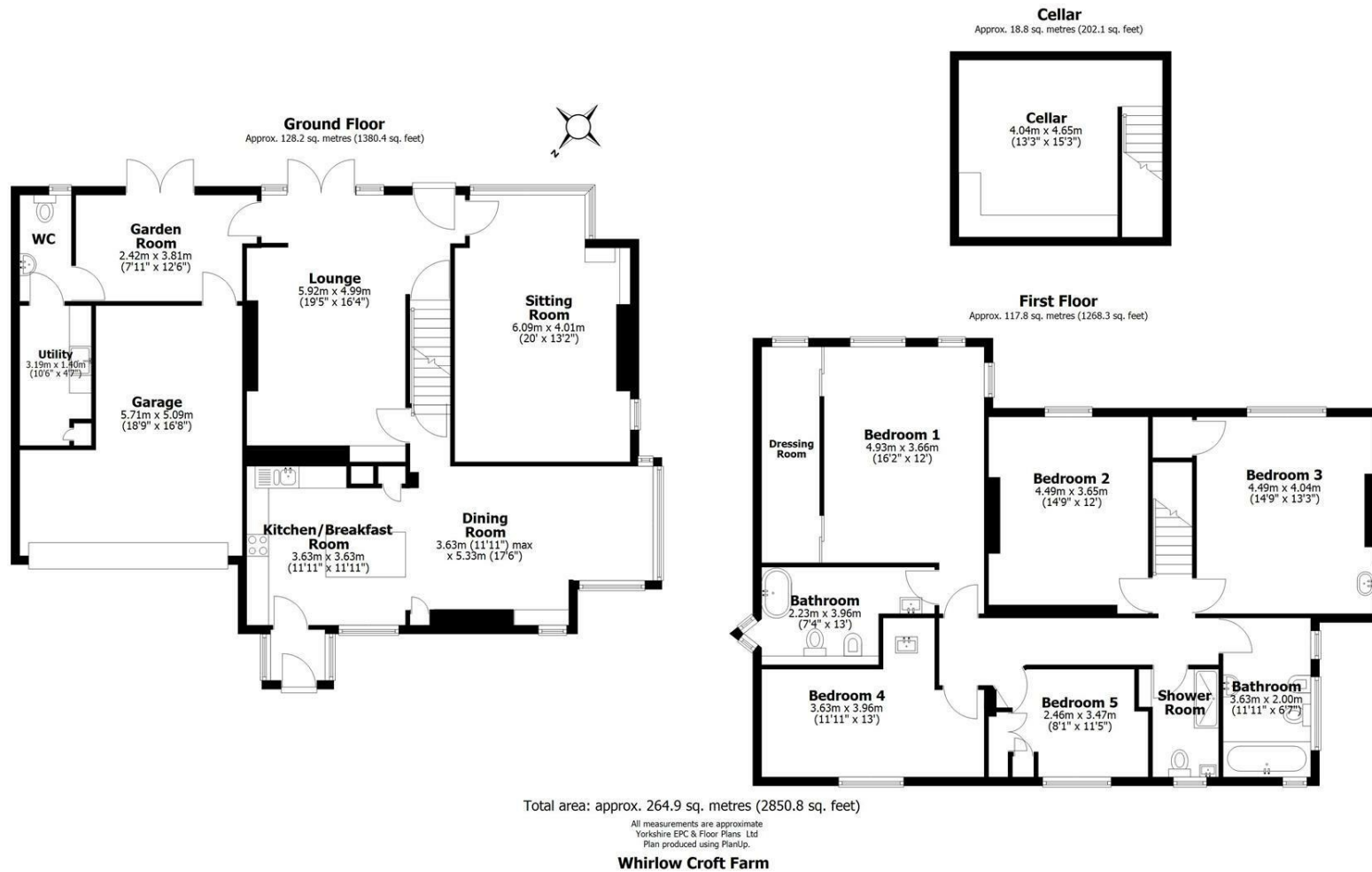

Spencer.

+44 (0)114 268 3682
info@spencersestateagents.co.uk

469 Ecclesall Road, Sheffield, S11 8PP
SpencersEstateAgents.co.uk

SpencersAgents
SpencersAgents
SpencersEstateAgents

All enquiries and negotiations conducted via the Spencers office. We are obliged under the Estate Agent Act 1991 to qualify all offers and an independent mortgage consultant will speak to you to substantiate your details. The particulars are set out as a general outline only for guidance and do not constitute part of an offer or contract. Measurements are given in good faith and believed to be correct. Any prospective buyer should satisfy themselves as to the correctness of all statements and should not rely on them as representation of fact. no person in the employment of Spencers has any authority to make or give representation or warranty whatever in relation to this property.

Viewing: Via the Agents
Spencers Agents Ltd, 469 Ecclesall Road, Sheffield S11 8pp | Registered in England No. 7565948